

PG57 Planetary Gearhead

UHV Planetary Gearhead for use with D57 Series Stepper Motors

The PG57 series gearheads couple directly to the AML D57 stepper motor and are suitable for use in UHV environments. Primarily used for increasing resolution, torque multiplication and inertia matching. They are designed for maximum torque capacity, high efficiency and low backlash.



FEATURES

- Suitable for use below 1×10^{-10} mBar
- Multiple ratio options, 3:1 through 100:1
- High efficiency, >94%
- Low inertia
- High precision, low backlash
- Service life >10,000 Hrs
- Bakeable to 200°C
- RoHS compliant

SPECIFICATIONS

Reduction Ratio	Nominal Output Torque	Maximum Acceleration Torque	Gear Inertia	Backlash ¹⁾	Efficiency at nominal torque	Radial Load ²⁾	Axial Load ²⁾	Mass	Lubrication
(:1)	Nm	Nm	kg-cm ²	arc-min	%	N	N	kg	
3	12.0	24.0	0.140	<12	96	665	765	1.2	Nyetorr 6300
4	18.9	36.4	0.100						
5	19.6	36.4	0.084						
7	16.7	33.4	0.075						
10	10.6	21.2	0.007						
12	18.2	36.4	0.097	<16	94			1.6	
15	19.4	36.4	0.083						
20	21.5	40.0	0.083						
25	20.0	40.0	0.083						
30	22.5	40.0	0.070						
40	21.5	40.0	0.070						
50	20.0	40.0	0.070						
70	16.7	33.4	0.070						
100	10.6	21.2	0.070						
Nominal input speed: 4500 rpm Maximum input speed: 8000 rpm Direction of rotation: Same as input Vacuum environment: <1 x 10 ⁻¹⁰ Max. temperature: +200°C <small>(1) Measured at 2% of rated torque (2) @100rpm, radial load applied at centre of shaft</small>									

DIMENSIONS

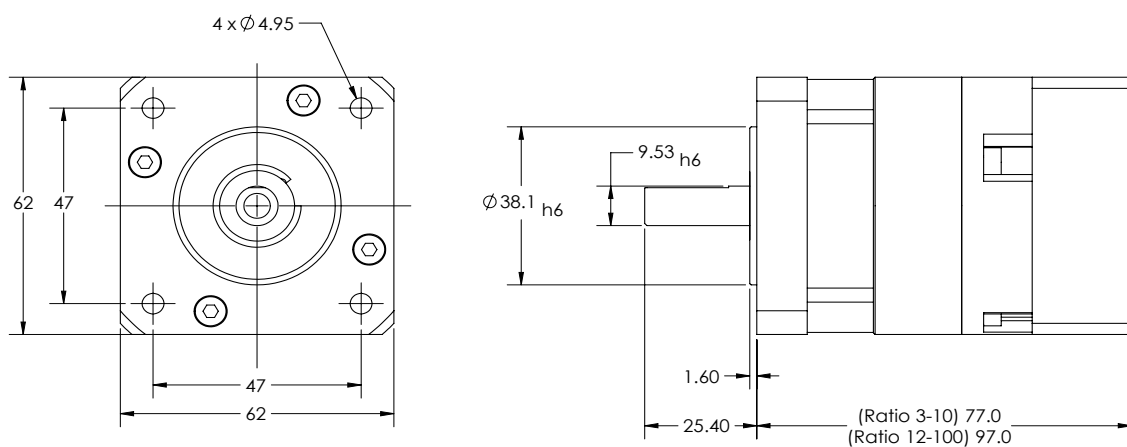

ORDERING INFORMATION

Order Code	
PG57-xx	Precision Planetary Gearhead
Related products	
D57.1	180mNm UHV Stepper Motor

AML pursues a policy of continuous improvement and reserves the right to make detail changes to specifications without consultation. E and OE.

Order code format

	PG57-	10
Order Code		
Ratio		



Arun Microelectronics Ltd
Bury Mill Farm
Bury Gate
Bury
PULBOROUGH
RH20 1NN

Tel: +44 (0)1903 884141
email: sales@arunmicro.com